

# 2 THE SITE

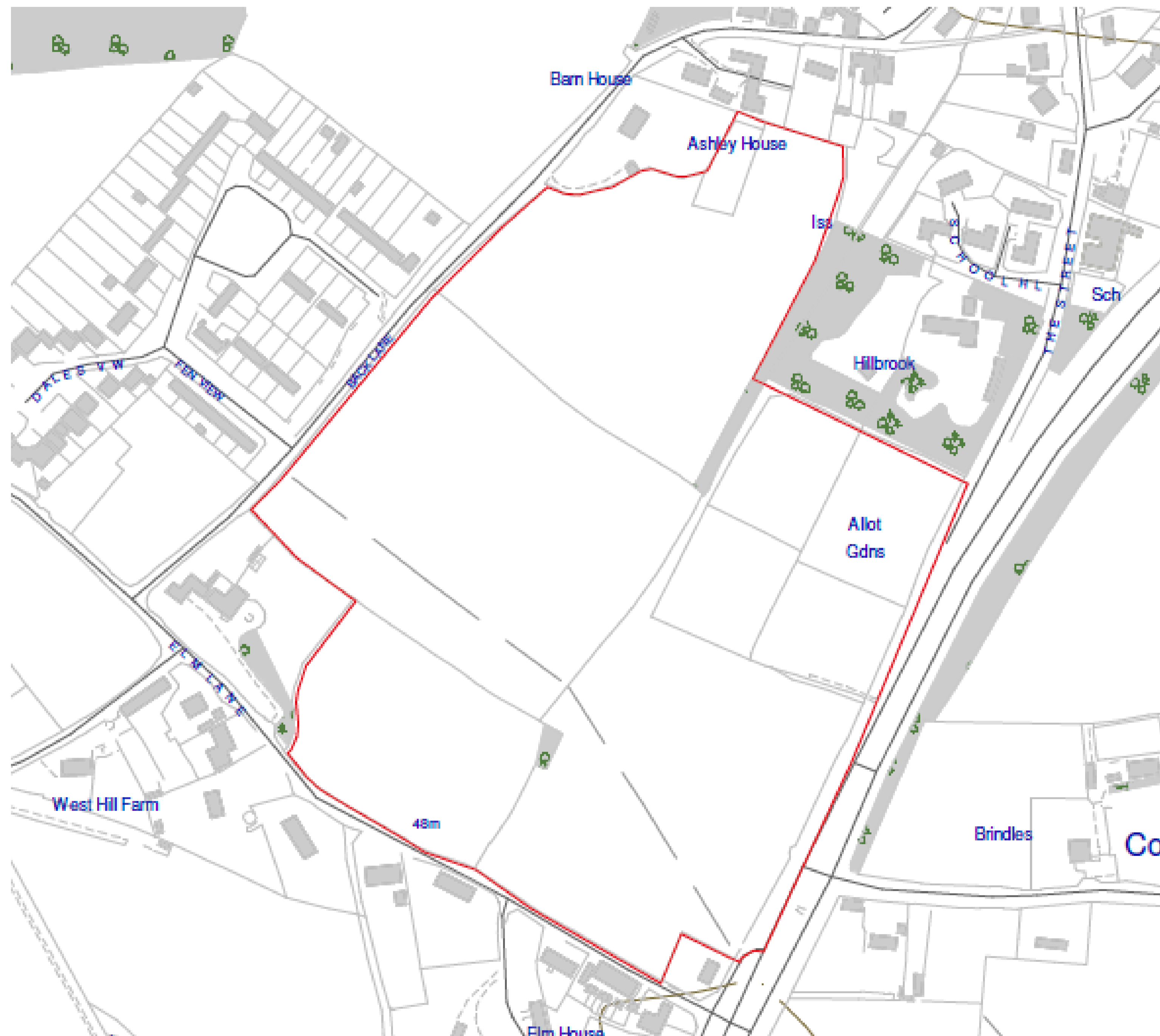

The application site is illustrated in red on the site location plan to the left. The site is adjacent to but outside the settlement boundary of the parish of Copdock and Washbrook.

The site, which measures 13 hectares in size, is currently used as agricultural land. Allotment gardens can be found at the north-east of the site, fronting onto London Road.

The site is bound by residential development on Back Lane to its west and residential dwellings to its south along Elm Lane. Open farmland can be found to its east, separated by London Road, with Copdock Primary School and further housing located to its north.

There is no relevant planning history related to this site.